

CHLORIDE TEST PROCEDURE



The Chloride test procedure utilizes the **STANDARD STRIP METHOD** using the eXact iDip® Smart Photometer System®. For tips on achieving best accuracy, and additional information regarding features of the eXact iDip® photometer and the eXact iDip® app, please refer to the eXact iDip® Quick Start Guide. You can download a copy on our website at sensafe.com/idip.

YOU WILL NEED

- eXact iDip® photometer
- Your smartphone/tablet with the eXact iDip® app installed
- (1) eXact® Strip Micro Chloride (Part no. 486757)
- Water sample for rinsing and testing

1 SELECT CUSTOMER

- Select **'Customers'** from the Home screen.
- Choose customer from list
OR Tap **'Add customer from contacts'** and choose customer from your contacts list
OR Tap **'+'** to create a new customer

Android users: If no address is found, tap "No addresses found"

- Verify customer has been selected

Note: In order to take full advantage of the GPS and Data Storage features, each test result must be linked to a contact. Individual users may select their own contact listing.

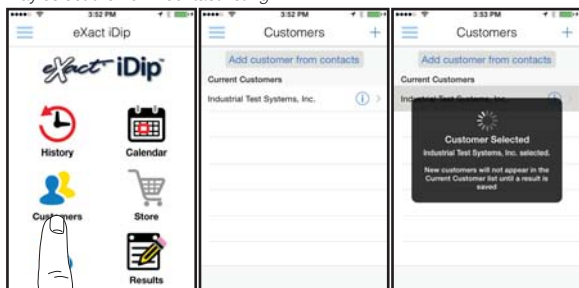

a

b

c

2 POWER ON EXACT IDIP®

Press the **ZERO/ON** button to power on the eXact iDip® photometer.

3 SELECT BLUETOOTH TEST

Tap the menu slide out **'≡'** and select **'Bluetooth Test'** from the choices shown.

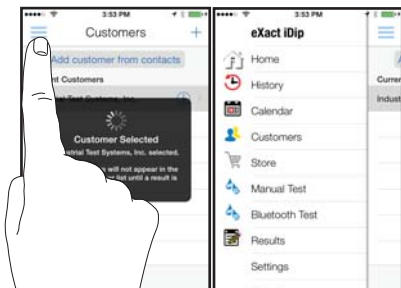

4 CONNECT EXACT IDIP®

The eXact iDip® app will automatically connect to the most recently used eXact iDip® photometer. If not, select your eXact iDip® from the bottom of the screen.

Note: Ensure you always connect your eXact iDip® photometer via the Bluetooth® connection within the app. If you experience an issue connecting your device, check to ensure that your smartphone/tablet's Bluetooth® function is turned on and your device is compatible.

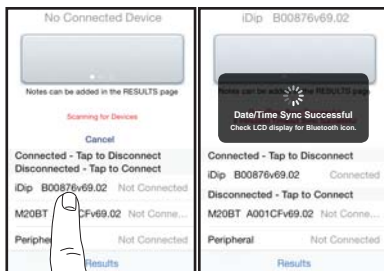

5 SELECT TEST

Tap **'SELECT Test'** at the top and select **Chloride (as NaCl) CH** (if this is not visible, purchase the test from the Store). The eXact iDip® photometer and eXact iDip® app will both display the test selection for Chloride.



6 FILL CELL

Rinse the cell 3 times with the water sample to be tested, then **FILL** cell to the top to begin test.



7 ZERO METER

Press **ZERO/ON** and the eXact iDip® photometer display reads **0PPM** indicating the meter is ready for testing.

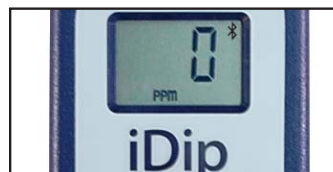

8 REMOVE STRIP

Remove one eXact® Strip Micro Chloride III (Part no. 486757) and set in a dry, convenient place. Replace cap on bottle.



9 DIP STRIP

Press **READ** to initiate a 20 second countdown and simultaneously **DIP** the eXact® strip by submerging all pads in the sample. Use a gentle constant back and forth motion (2 strokes per second) until the timer displays "1". Remove and discard the strip.



10 READ RESULTS

READ result displayed as Chloride.

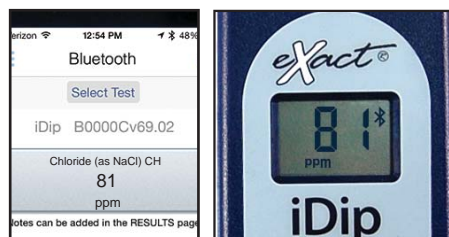

TIPS

- Before running test unlock Chloride test by purchasing in the Store.
- To obtain optimal accuracy when testing in direct sunlight, use the Cell Cover when zeroing and reading the sample.
- It is recommended to use the Cell Cleaning Brush with water to clean the CELL after each test to remove reagents which coat the CELL wall.

MANAGE YOUR RESULTS

Save, send, and share results instantly using the eXact iDip® app. For step-by-step instructions, refer to the eXact iDip® Quick Start Guide. You can download a pdf copy on-line at sensafe.com/i-dip.



eXact iDip

